

# 0.8t → 6.3t

# V LEVER

# VR2

**VITAL**  
LEVER

## Lever hoists

### Light Weight, High Quality!

For plated parts,  
we use  
trivalent chromate  
treatment,  
which is  
environment friendly.



Lifting



Lowering



Fastening



Pulling



VITAL brand is registered worldwide.

For Lifting, Lowering, Fastening and Pulling.



Lever hoists

V LEVER VR2

### Idling operation:

1. Depress the retaining pawl all the way down and pull the grip ring towards you.
2. The chain can be adjusted up and down by hand.
3. To terminate the idling, set the change lever in the down (↓) position. (See diagram at right).  
Then, depressing the retaining pawl as far as possible, push the grip ring gently so as to let the pawl engage the outer edge of the retaining plate.  
Next, grip the grip ring and handle with a single hand and push them while turning them counterclockwise.  
The retaining pawl returns to its original position.

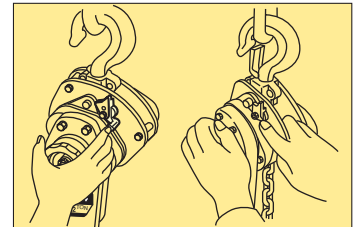

0.8 t



1 t



1.6 t



3.2 t



6.3 t

### Specifications

| Model Number                     | VR2-08 | VR2-10 | VR2-15 | VR2-30 | VR2-60 |     |
|----------------------------------|--------|--------|--------|--------|--------|-----|
| Capacity (t)                     | 0.8    | 1      | 1.6    | 3.2    | 6.3    |     |
| Standard Lift (m)                | 1.5    | 1.5    | 1.5    | 1.5    | 1.5    |     |
| Net Weight (kg)                  | 6.9    | 7.1    | 9.7    | 16.3   | 26.7   |     |
| Min. Distance between Hooks (mm) | 295    | 310    | 335    | 405    | 550    |     |
| Pull Required to Lift Full Load  | (kgf)  | 15     | 20     | 18     | 38     | 39  |
|                                  | (N)    | 147    | 196    | 177    | 373    | 382 |
| Chain thickness (mm)             | 6.3    | 6.3    | 7.1    | 9.0    | 9.0    |     |
| Dimension                        | a (mm) | 148    | 148    | 163.5  | 191    | 191 |
|                                  | b (mm) | 128    | 128    | 148    | 181    | 244 |
|                                  | c (mm) | 295    | 310    | 325    | 395    | 550 |
|                                  | d (mm) | 256    | 256    | 368    | 368    | 368 |
|                                  | e (mm) | 27     | 30     | 34     | 43     | 47  |

\* Hoists with the life in other lengths are also available.

\* Please note that the specifications on this leaflet may be modified for improvements without notice.

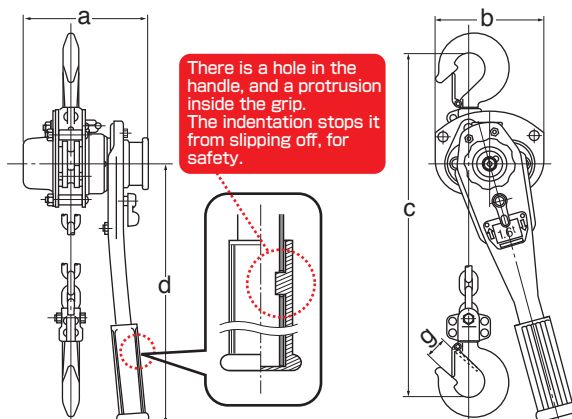

Vital offers products that are designed for longtime use, providing the lowest possible per-use cost.

Since 1933  
VITAL CHAIN BLOCK MFG.CO.,LTD.